

CONTINENTAL

The Quality Line

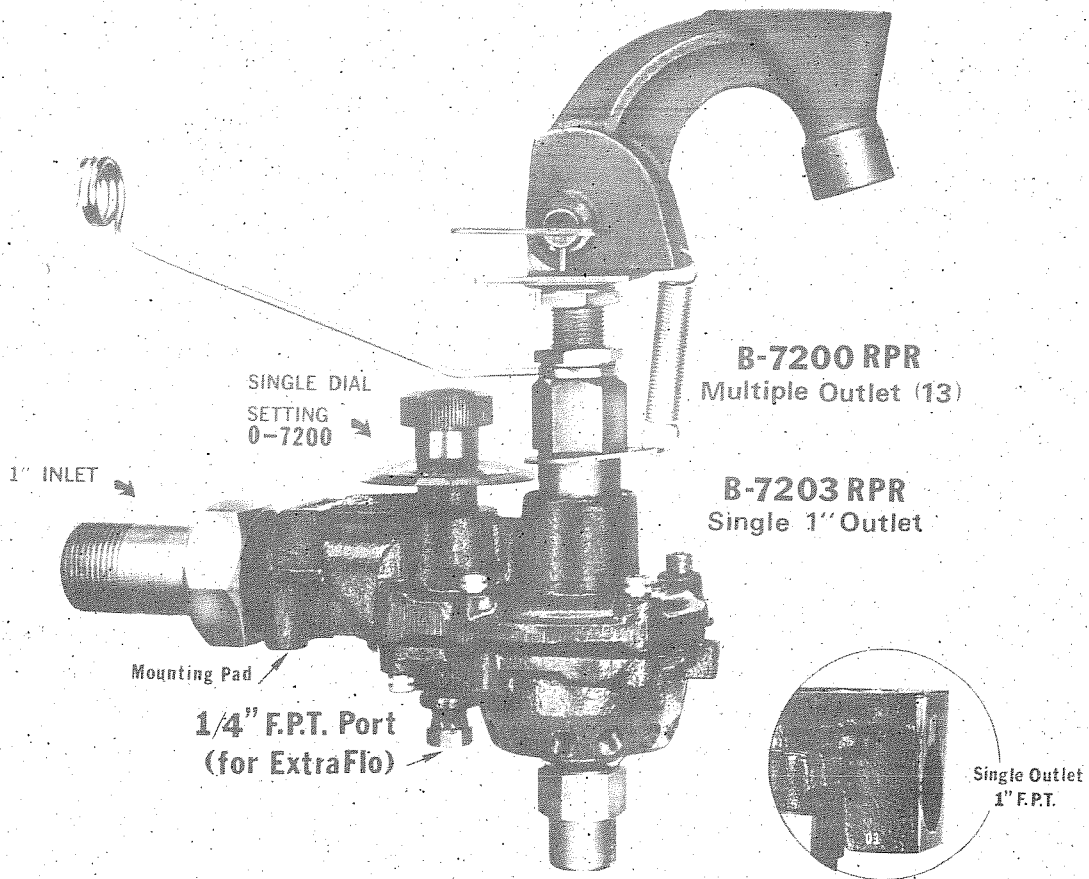

B-7200 SERIES *MeterMatic*

OPERATION AND SERVICE INSTRUCTIONS

CONTINENTAL NH₃ PRODUCTS CO., INC.

A-72-01	UPPER BODY ASSEMBLY W/ METER BARREL AND DIAL
72-02	LOWER BODY, 13 OUTLETS
72-03	LOWER BODY, 1 IN. OUTLET
01-04	LEVER, ROPE PULL CASTING
65-11B	ADJUSTING SCREW
65-13	CAM ROD
01-14	LOCK NUT (2 REQ'D)
01-15	STEM
65-18	HALF UNION, 1 IN.
65-19	UNION NUT
65-20	RATCHET CAM
01-21	RATCHET PAWL
01-22	CAM HOUSING
A-72-24	BONNET ASSEMBLY
65-26	SPRING RETAINER PLUG
01-30B	CAM HOUSING CAP
01-30DS	DRIVE SCREW (2 REQ'D)
01-31	PACKING RETAINER
72-33B	CAP SEAL RETAINER WASHER
72-34	LOWER STEM
72-35	THROTTLE SEAT
A-65-37	SEAT ASSEMBLY
72-39B	METER BARREL
A-72-41	FILTER PULL ASSEMBLY
72-53	ORIFICE SEAT INSERT
01-60F	TEFLON PACKING (SET OF 3)
01-64F	ROPE
01-70F	"O" RING STEM SEAL
72-71BF	CAPSEAL
72-72	DIAPHRAGM
01-74F	"O" RING SEAL
72-75	RETAINER WASHER
01-80	UPPER DIAPHRAGM PLATE
65-81	LOWER DIAPHRAGM PLATE
A-72-82BF	DIAL ASSEMBLY
72-83FX	STRAINER SCREEN
72-84F	SPRING BRACKET
01-85F	INDICATOR FLAG
01-86F	RATCHET STOP PLATE
01-87	ROPE GUIDE WASHER
01-88	RETAINER WASHER
01-89	WAVE WASHER (2 REQ'D)
72-90	METER SPRING
65-91	SHUT-OFF SPRING
01-92	RETURN SPRING
01-92BF	LOCK PIN
01-93	PAWL SPRING
01-94F	FLAG LOCK PIN
01-95	CAM ROD SPRING
01-97	ROPE GUIDE
01-832-25	DIAL SET SCREW
01-2520-100	BODY CAP SCREW (6 REQ'D)
01-3118-25	SPRING RETAINER SCREW

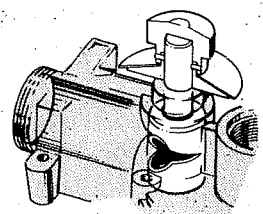
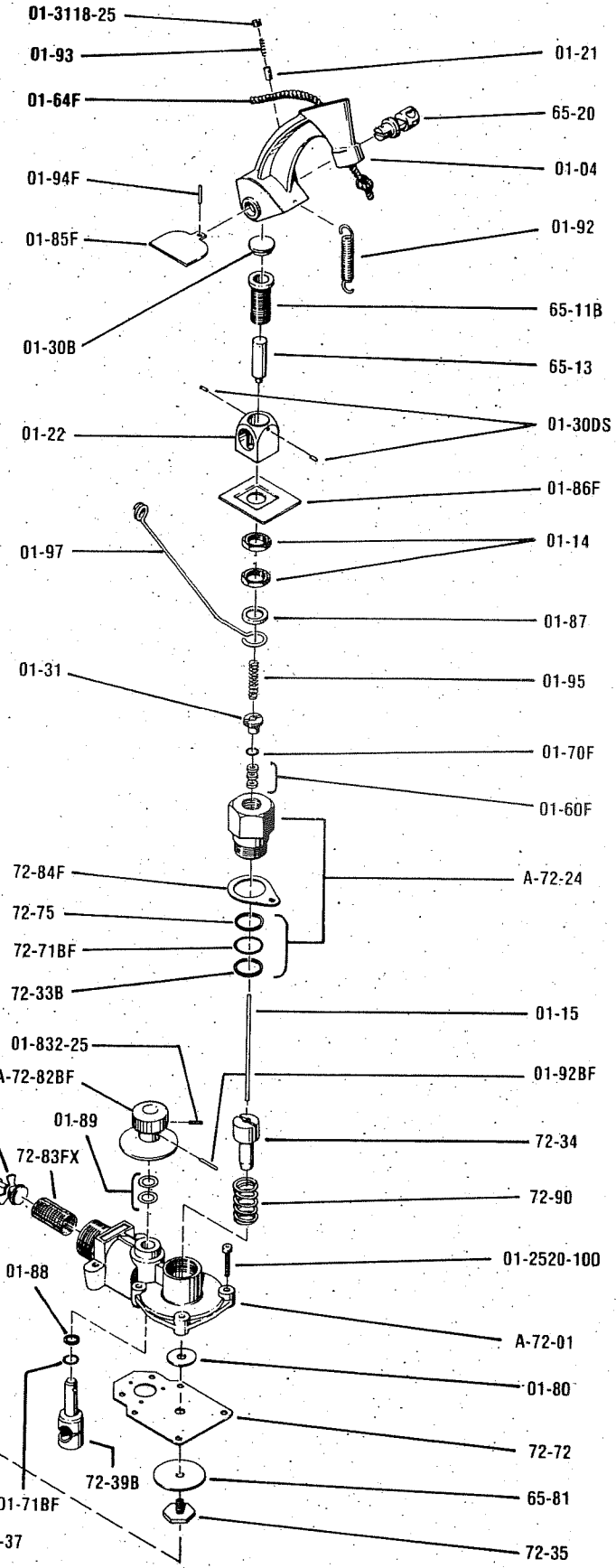

**B-7200 Series
METER-MATIC**

B-7200 SERIES METER MATIC

SETTING INSTRUCTIONS

Although the principle of metering of the B-7200 Series Meter Matic is identical to the previous A-6000 and A-6500 Models, due to the fact that the metered output is much greater, the method of computing the setting will vary depending on tank pressure.

Referring to Fig. 1 it will be noted that the setting numbers around the perimeter of the dial is 0 - 7200. These numbers represent pounds of NH_3 per hour of metered output.

Also shown on the dial, Fig. 1, are three formulas for computing settings at various tank pressures:

40 - 50 LB. TANK PRESSURE SWATH FT. X .215 X MPH X LBS. 'N' = SETTING
--

70 - 80 LB. TANK PRESSURE SWATH FT. X .2 X MPH X LBS. 'N' = SETTING
--

120 - 150 LB. TANK PRESSURE SWATH FT. X .15 X MPH X LBS. 'N' = SETTING

NOTE - Because there are many variables in existing applying equipment, such as hose size and length, break-a-way couplings and connectors, tank and hose-end valving, etc., the actual setting may vary from one piece of equipment to another. Setting charts for the more popular swaths will be found on the last pages of these instructions. Individual vinyl decals for these swath widths are also available.

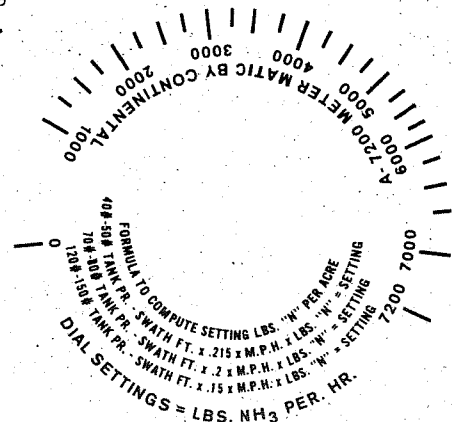

FIGURE 1

CARE AND MAINTENANCE

The METER MATIC is a precision metering device and as such will perform more accurately and for a much longer period of maintenance free operation if only a few simple precautions are followed.

1. The unit should be protected from the elements as much as possible when not in actual use and service.
2. At close of applying season, or if out of service for an extended period of time, disconnect meter and clean thoroughly of sediment or foreign matter from meter-barrel housing, manifold and shut-off bonnet assembly.*

* This is absolutely a MUST when additives are used with NH_3 .

- CAUTION - BE ABSOLUTELY CERTAIN THAT ALL SUPPLY VALVES, FITTINGS AND HOSES ARE COMPLETELY EVACUATED FROM METER MATIC BEFORE BREAKING CONNECTIONS.
--

3. Apply generous amount of light lubricating oil on meter-barrel, both below the dial and through the inlet opening.
4. Rotate dial several times to allow oil to penetrate seal, barrel and housing.
5. Store inside of building during off-season if at all possible.

PROBLEM - CAUSE - SOLUTION

A. INACCURACY - UNDER APPLICATION

1. Dial Setting - Check setting instructions - Calculations - Speed - Swath.
2. Adequate Liquid Supply - Hose Restriction - Valving - Couplings - Strainer
Auxiliary Shut-off Valves - Tank Content.
3. Improper adjustment of Quick Shut-off - Not fully open - See instruction
ASSEMBLY 'B' 1.
4. Insufficient Tank Pressure - See charts for various tank pressures.
5. Excessive Frosting - An indication of restriction - Frosting of lower body is
normal - Frosting of upper body requires investigation.

B. INACCURACY - OVER APPLICATION

1. Dial Setting - 'A' - 1. above.
2. Ruptured Diaphragm (72-72) - Replace - See DISASSEMBLY 'B'.
3. Restriction of Meter-Barrel Canal - Remove lower body - See DISASSEMBLY 'B' -1.
Clean if necessary.
4. Throttle Stem (72-34) sticking in bonnet assembly (A-72-24). Note: If the turning
of Dial neither increases or decreases output this is probable cause.
 - a. To correct - Replace bonnet assembly (A-72-24). See DISASSEMBLY 'B' - 2.
 - b. Check to determine if stem (72-34) engages smoothly.
 - c. Check stem (01-15) for corrosion or excessive wear.

C. LEAKS

1. If leak develops at diaphragm between upper and lower bodies it can usually be
stopped by tightening cap screws (01-2520-100). If this does not correct, check
diaphragm for crease or cut and replace if necessary. See DISASSEMBLY 'B'.
2. Leak thru discharge hose when Quick Shut-off is closed.
NOTE: The shut-off is designed to function as a safety relief in the event tank
valve is left open and pressure allowed to build up in the METER-MATIC.
Tank valve should always be closed and hose and meter evacuated when not
in use.
 - a. Foreign substance lodged or imbedded in seat (A-65-37) See DISASSEMBLY 'A'.
 - b. Damaged or excessively worn seat (A-65-37).
 - c. Check Quick Shut-off adjustment. See ASSEMBLY 'B'.
3. Leak thru and around Cam Housing Assembly (01-22). Check and adjust stem pack-
ing - See DISASSEMBLY 'C'
4. Leak under dial - See CARE & MAINTENANCE 3 & 4

DIS-ASSEMBLY

For field repair and maintenance of the METER MATIC the following instructions
and procedures are suggested. If only limited knowledge of the Meter is known it
is not recommended that major overhaul be attempted.

CAUTION

BE ABSOLUTELY CERTAIN THAT ALL SUPPLY VALVES, FITTINGS, HOSES AND
THE METER-MATIC HAVE BEEN COMPLETELY EVACUATED BEFORE ATTEMPTING
ANY TYPE OF REPAIR OR MAINTENANCE.

A. REPLACE QUICK SHUT-OFF SEAT

1. Remove spring retainer plug (65-26).
2. Remove seat assembly (A-65-37) and replace with new part.

B. REPLACE DIAPHRAGM

1. Remove six cap screws (01-2520-100) and remove lower body.
2. Remove bonnet assembly (A-72-24) by turning counter clockwise.
3. Holding screw driver in slot of stem (72-34) back out throttle seat (72-35).
4. Upper diaphragm plate (65-81) and diaphragm (72-72) can then be removed.
5. Replace diaphragm with new part and re-assemble.

C. ADJUST OR REPLACE QUICK SHUT-OFF STEM AND PACKING

1. Loosen lower lock nut (01-14) and remove adjusting screw and cam assembly. by turning counter clockwise. (65-11B and 01-22)
2. Remove Quick-Shut-off seat assembly. See DISASSEMBLY -'A'
3. To tighten packing (01-60F) - Depress stem (01-15) until screw driver will engage slot in packing follower (01-31). Turn clockwise.
4. To remove packing - Turn follower counter clockwise and remove.
5. Replace 'O' ring (01-70F) and packing if necessary - Re-assemble.
6. Re-assemble bonnet, adjusting screw, etc. See ASSEMBLY 'A' & 'B'.

D. REPLACE CAP SEAL IN UPPER BODY BENEATH DIAL

1. Remove lower body. See DISASSEMBLY -'B'-1.
2. Apply penetrating oil or solvent to meter-barrel, both below dial and thru screen opening. Allow sufficient time for penetration to seal, barrel, and body housing.
3. Loosen set screw (01-832-25) in dial knob.
4. Drive out lock pin (01-92BF). Support knob to prevent damage to meter stem.
5. Remove burrs caused by set screw and lock pin from barrel stem. Failure to do so will damage new seal when re-assembled.
6. Press meter barrel out of housing. DO NOT DRIVE OUT. If meter barrel is badly corroded, return upper body assembly to Factory for overhaul.
7. Remove old cap seal (01-71BF) and thoroughly clean both barrel and housing. It may be necessary to remove corrosion with steel wool.
8. Insert new cap seal (01-71BF) into recess of body. Be careful not to twist new seal during installation. Use a dab of cup grease to hold seal in place.
9. Insert meter barrel back into body and replace dial assembly. Be sure that dial and orifice of meter barrel is in the same position as when removed.

ASSEMBLY

Before proceeding with assembly all parts must be thoroughly clean and free of scale, grit, etc. All parts with the exception of diaphragm should be lightly oiled before re-assembly.

A. QUICK SHUT-OFF BONNET ASSEMBLY

1. Insert lower stem (72-34) into bonnet assembly (A-72-24).
2. Install meter spring (72-90) over stem (72-34) and hand tighten bonnet in body, being sure the spring fits squarely in recess of body.
3. Assemble new diaphragm (72-72) between upper (01-80) and lower (65-81) plates and hand tighten to stem (72-34) by inserting throttle seat (72-35).
4. With bonnet assembly removed, hold stem (72-34) with screw driver in slot and tighten throttle seat (72-35) securely to stem with wrench.
5. Re-insert bonnet assembly and tighten securely into upper body with wrench.
6. Install lower body by reversing operation -DISASSEMBLY 'B'-2 . Care should be exercised to see that diaphragm fits smoothly and is free of wrinkles.
7. Assemble shut-off seat assembly (A-65-37) , spring and plug (65-91) - (65-26) into body.

B. ADJUST QUICK SHUT-OFF ASSEMBLY

1. Loosen lower lock nut (01-14) and raise or lower adjusting screw (65-11B) until cam rod (65-13), stem (01-15) and seat (A-65-37) contact each other. Turn adjusting screw counter clockwise 1/4 turn and lock down securely with lower lock nut. The cam, stems and seat are now in correct adjustment.
2. Loosen upper lock nut and turn rope pull lever to desired position.

* CAUTION *

BEFORE CONNECTING REPAIRED UNIT TO AMMONIA - CHECK ALL CONNECTIONS, ASSEMBLY PROCEDURES AND ADJUSTMENTS WITH AIR PRESSURE FOR LEAKS.

B-7200 METER MATIC SETTING CHART

DIAL SETTING 200" (INCH) SWATH											DIAL SETTING 252" (INCH) SWATH											
TRACTOR SPEED (MPH)	TANK PRESSURE (PSI)	LBS. N (NITROGEN) PER ACRE									TRACTOR SPEED (MPH)	TANK PRESSURE (PSI)	LBS. N (NITROGEN) PER ACRE									
		60	80	100	110	130	150	175	200	220			60	80	100	110	130	150	175	200	220	
3	120-150					975	1125	1315	1500	1650	3	120-150					1040	1230	1420	1655	1890	2080
	70-80			1000	1100	1300	1500	1750	2000	2200		70-80		1010	1260	1385	1640	1890	2205	2520	2770	
	40-50			1075	1185	1400	1610	1880	2150	2365		40-50		1085	1355	1490	1760	2030	2370	2710	2980	
4	120-150			1000	1100	1300	1500	1750	2000	2200	4	120-150		1010	1260	1385	1640	1890	2205	2520	2770	
	70-80		1065	1335	1465	1735	2000	2335	2665	2935		70-80	1010	1345	1680	1850	2185	2520	2940	3360	3695	
	40-50		1145	1435	1575	1865	2150	2510	2865	3155		40-50	1085	1445	1805	1985	2350	2710	3160	3610	3975	
4-1/2	120-150			1125	1240	1465	1690	1970	2250	2475	4-1/2	120-150		1135	1420	1560	1845	2125	2480	2835	3120	
	70-80		1200	1500	1650	1950	2250	2625	3000	3300		70-80	1135	1510	1890	2080	2455	2835	3310	3780	4160	
	40-50	970	1290	1615	1775	2095	2420	2825	3225	3550		40-50	1220	1625	2030	2235	2640	3050	3555	4065	4470	
5	120-150		1000	1250	1375	1625	1875	2190	2500	2750	5	120-150		1260	1575	1735	2050	2365	2755	3150	3465	
	70-80	1000	1335	1665	1835	2165	2500	2915	3335	3665		70-80	1260	1680	2100	2310	2730	3150	3675	4200	4620	
	40-50	1075	1435	1790	1970	2330	2690	3135	3585	3940		40-50	1355	1805	2260	2485	2935	3385	3950	4515	4965	
5-1/2	120-150		1100	1375	1515	1790	2065	2405	2750	3025	5-1/2	120-150	1040	1385	1735	1905	2250	2600	3030	3465	3810	
	70-80	1100	1465	1835	2015	2385	2750	3210	3665	4035		70-80	1385	1850	2310	2540	3005	3465	4045	4620	5080	
	40-50	1185	1575	1970	2170	2565	2955	3450	3940	4335		40-50	1490	1985	2485	2730	3230	3725	4345	4965	5465	
6	120-150		1200	1500	1650	1950	2250	2625	3000	3300	6	120-150	1135	1510	1890	2080	2450	2835	3310	3780	4160	
	70-80	1200	1600	2000	2200	2600	3000	3500	4000	4400		70-80	1510	2015	2520	2770	3275	3780	4410	5040	5545	
	40-50	1290	1720	2150	2365	2795	3225	3765	4300	4730		40-50	1625	2165	2710	2980	3520	4065	4740	5420	5960	
6-1/2	120-150	975	1300	1625	1790	2115	2440	2845	3250	3575	6-1/2	120-150	1230	1640	2050	2250	2660	3070	3585	4095	4505	
	70-80	1300	1735	2165	2385	2915	3250	3790	4335	4765		70-80	1640	2185	2730	3005	3550	4095	4780	5460	6005	
	40-50	1400	1865	2330	2560	3030	3495	4075	4660	5125		40-50	1760	2350	2935	3230	3815	4400	5135	5870	6455	
7	120-150	1050	1400	1750	1925	2275	2625	3065	3500	3850	7	120-150	1325	1765	2205	2425	2865	3310	3860	4410	4850	
	70-80	1400	1865	2335	2565	3035	3500	4085	4665	5135		70-80	1765	2350	2940	3235	3820	4410	5145	5880	6470	
	40-50	1505	2005	2510	2760	3260	3765	4390	5015	5520		40-50	1895	2530	3160	3475	4110	4740	5530	6320	6955	
8	120-150	1200	1600	2000	2200	2600	3000	3500	4000	4400	8	120-150	1510	2015	2520	2770	3275	3780	4410	5040	5545	
	70-80	1600	2135	2665	2935	3465	4000	4665	5335	5865		70-80	2015	2670	3360	3695	4370	5040	5880	6720	-	
	40-50	1720	2295	2865	3155	3725	4300	5015	5735	6305		40-50	2165	2890	3610	3975	4695	5420	6320	7200	-	
DIAL SETTING 280" (INCH) SWATH											DIAL SETTING 324" (INCH) SWATH											
TRACTOR SPEED (MPH)	TANK PRESSURE (PSI)	LBS. N (NITROGEN) PER ACRE									TRACTOR SPEED (MPH)	TANK PRESSURE (PSI)	LBS. N (NITROGEN) PER ACRE									
		60	80	100	110	130	150	175	200	220			60	80	100	110	130	150	175	200	220	
3	120-150			1050	1155	1365	1575	1840	2100	2310	3	120-150			1215	1335	1580	1825	2125	2430	2675	
	70-80		1120	1400	1540	1820	2100	2450	2800	3080		70-80		1295	1620	1780	2105	2430	2835	3240	3565	
	40-50		1205	1505	1655	1955	2260	2635	3010	3310		40-50	1045	1395	1740	1915	2265	2610	3050	3485	3830	
4	120-150		1120	1400	1540	1820	2100	2450	2800	3080	4	120-150	970	1295	1620	1780	2105	2430	2835	3240	3565	
	70-80	1120	1495	1865	2055	2425	2800	3265	3735	4105		70-80	1295	1730	2160	2375	2810	3240	3780	4320	4750	
	40-50	1205	1605	2005	2205	2610	3010	3510	4015	4415		40-50	1395	1860	2320	2555	3020	3485	4065	4645	5110	
4-1/2	120-150		1260	1575	1735	2050	2365	2755	3150	3465	4-1/2	120-150	1095	1460	1825	2005	2370	2735	3190	3645	4010	
	70-80	1260	1680	2100	2310	2730	3150	3675	4200	4620		70-80	1460	1945	2430	2675	3160	3645	4255	4860	5345	
	40-50	1355	1805	2260	2485	2935	3385	3950	4515	4965		40-50	1565	2090	2610	2875	3395	3920	4570	5225	5745	
5	120-150	1050	1400	1750	1925	2275	2625	3065	3500	3850	5	120-150	1215	1620	2025	2230	2635	3040	3545	4050	4455	
	70-80	1400	1865	2335	2565	3035	3500	4085	4665	5135		70-80	1620	2160	2700	2970	3510	4050	4725	5400	5940	
	40-50	1505	2005	2510	2760	3260	3760	4390	5015	5520		40-50	1740	2320	2905	3195	3775	4355	5080	5805	6385	
5-1/2	120-150	1155	1540	1925	2115	2505	2890	3370	3850	4235	5-1/2	120-150	1335	1780	2230	2450	2895	3340	3900	4455	4900	
	70-80	1540	2055	2565	2825	3335	3850	4490	5135	5645		70-80	1780	2375	2970	3265	3860	4455	5200	5940	6535	
	40-50	1655	2205	2760	3035	3585	4140	4830	5520	6070		40-50	1915	2555	3195	3510	4150	4790	5590	6385	7025	
6	120-150	1260	1680	2100	2310	2730	3150	3675	4200	4620	6	120-150	1460	1945	2430	2675	3160	3645	4255	4860	5345	
	70-80	1680	2240	2800	3080	3640	4200	4900	5600	6160		70-80	1945	2590	3240	3565	4210	4860	5670	6480	7130	
	40-50	1805	2410	3010	3310	3915	4515	5270	6020	6620		40-50	2090	2785	3485	3830	4530	5225	6095	6965	-	
6-1/2	120-150	1365	1820	2275	2500	2960	3415	3980	4550	5005	6-1/2	120-150	1580	2105	2635	2895	3420	3950	4605	5265	5790	
	70-80	1820	2425	3035	3335	3945	4550	5310	6065	6675		70-80	2105	2810	3510	3860	4565	5265	6145	7020	-	
	40-50	1955	2610	3260	3585	4240	4890	5705	6520	7175		40-50	2265	3020	3775	4150	4905	5660	6605	-	-	
7	120-150	1470	1960	2450	2695	3185	3675	4290	4900	5390	7	120-150	1700	2270	2835	3120	3685	4255	4960	5670	6235	
	70-80	1960	2615	3265	3595	4245	4900	5715	6535	7185		70-80	2270	3025	3780	4160	4915	5670	6615	-	-	
	40-50	2105	2810	3510	3865	4565	5265	6145	7025	-		40-50	2440	3250	4065	4470	5285	6095	7110	-	-	
8	120-150	1680	2240	2800	3080	3640	4200	4900	5600	6160	8	120-150	1945	2590	3240	3565	4210	4860	5670	6480	7130	
	70-80	2240	2985	3735	4105	4855	5600	6535	-	-		70-80	2590	3455	4320	4750	5615	6480	-	-	-	
	40-50	2410	3210	4015	4415	5215	6020	7025	-	-		40-50	2785	3715	4645	5110	6035	6965	-	-	-	

B-7200 METER MATIC SETTING CHART

DIAL SETTING 360" (INCH) SWATH										DIAL SETTING 396" (INCH) SWATH											
TRACTOR SPEED (MPH)	TANK PRESSURE (PSI)	LBS. N ^o (NITROGEN) PER ACRE									TRACTOR SPEED (MPH)	TANK PRESSURE (PSI)	LBS. N ^o (NITROGEN) PER ACRE								
		60	80	100	110	130	150	175	200	220			60	80	100	110	130	150	175	200	220
3	120-150		1080	1350	1485	1755	2025	2365	2700	2970	3	120-150		1190	1485	1635	1930	2230	2600	2970	3265
	70-80	1080	1440	1800	1980	2340	2700	3150	3600	3960		70-80	1190	1585	1980	2180	2575	2970	3465	3960	4355
	40-50	1160	1550	1935	2130	2515	2905	3385	3870	4255		40-50	1275	1705	2130	2340	2765	3195	3725	4255	4685
4	120-150	1080	1440	1800	1980	2340	2700	3150	3600	3960	4	120-150	1190	1585	1980	2180	2575	2970	3465	3960	4355
	70-80	1440	1920	2400	2640	3120	3600	4200	4800	5280		70-80	1585	2110	2640	2905	3430	3960	4620	5280	5810
	40-50	1550	2065	2580	2840	3355	3870	4515	5160	5675		40-50	1705	2270	2840	3120	3690	4255	4965	5675	6245
4 1/2	120-150	1215	1620	2025	2230	2635	3048	3545	4050	4455	4 1/2	120-150	1335	1780	2230	2450	2895	3340	3900	4455	4900
	70-80	1620	2160	2700	2970	3510	4050	4725	5400	5940		70-80	1780	2375	2970	3265	3860	4455	5200	5940	6535
	40-50	1740	2320	2905	3195	3775	4355	5080	5805	6385		40-50	1915	2555	3195	3510	4150	4790	5590	6385	7025
5	120-150	1350	1800	2250	2475	2925	3375	3940	4500	4950	5	120-150	1.85	1980	2475	2725	3220	3715	4330	4950	5445
	70-80	1800	2400	3000	3300	3900	4500	5250	6000	6600		70-80	1980	2640	3300	3630	4290	4950	5775	6600	7200
	40-50	1935	2580	3225	3550	4195	4840	5645	6450	7095		40-50	2130	2840	3550	3900	4610	5320	6210	7095	-
5 1/2	120-150	1485	1980	2475	2725	3220	3715	4330	4950	5445	5 1/2	120-150	1635	2180	2725	2995	3540	4085	4765	5445	5990
	70-80	1980	2640	3300	3630	4290	4950	5775	6600	-		70-80	2180	2905	3630	3995	4720	5445	6355	7200	-
	40-50	2130	2840	3550	3900	4610	5320	6210	7095	-		40-50	2340	3120	3900	4295	5075	5855	6830	-	-
6	120-150	1620	2160	2700	2970	3510	4050	4725	5400	5940	6	120-150	1780	2375	2970	3265	3860	4455	5200	5940	6535
	70-80	2160	2880	3600	3960	4680	5400	6300	7200	-		70-80	2375	3170	3960	4355	5150	5940	6930	-	-
	40-50	2320	3095	3870	4255	5030	5805	6775	-	-		40-50	2555	3405	4255	4685	5535	6385	-	-	-
6 1/2	120-150	1755	2340	2925	3220	3805	4390	5120	5850	6435	6 1/2	120-150	1930	2575	3220	3540	4185	4825	5630	6435	7080
	70-80	2340	3120	3900	4290	5070	5850	6825	-	-		70-80	2575	3430	4290	4720	5575	6435	-	-	-
	40-50	2515	3355	4195	4610	5450	6290	-	-	-		40-50	2765	3690	4610	5075	5995	6920	-	-	-
7	120-150	1890	2520	3150	3465	4095	4725	5515	6300	6930	7	120-150	2080	2770	3465	3810	4505	5200	6065	6930	-
	70-80	2520	3360	4200	4620	5460	6300	-	-	-		70-80	2770	3695	4620	5080	6005	6930	-	-	-
	40-50	2710	3610	4515	4965	5870	6775	-	-	-		40-50	2980	3975	4965	5465	6455	-	-	-	-
8	120-150	2160	2880	3600	3960	4680	5400	6300	7200	-	8	120-150	2375	3170	3960	4355	5150	5940	6930	-	-
	70-80	2880	3840	4800	5280	6240	7200	-	-	-		70-80	3170	4225	5280	5810	6865	-	-	-	-
	40-50	3095	4130	5160	5675	6710	-	-	-	-		40-50	3405	4540	5675	6245	-	-	-	-	-
DIAL SETTING 432" (INCH) SWATH										DIAL SETTING 480" (INCH) SWATH											
TRACTOR SPEED (MPH)	TANK PRESSURE (PSI)	LBS. N ^o (NITROGEN) PER ACRE									TRACTOR SPEED (MPH)	TANK PRESSURE (PSI)	LBS. N ^o (NITROGEN) PER ACRE								
		60	80	100	110	130	150	175	200	220			60	80	100	110	130	150	175	200	220
3	120-150		1295	1620	1780	2105	2430	2835	3240	3565	3	120-150	1080	1440	1800	1980	2340	2700	3150	3600	3960
	70-80	1295	1730	2160	2375	2810	3240	3780	4320	4750		70-80	1440	1920	2400	2640	3120	3600	4200	4800	5280
	40-50	1395	1860	2320	2555	3020	3485	4065	4645	5110		40-50	1550	2065	2580	2840	3355	3870	4515	5160	5675
4	120-150	1295	1730	2160	2375	2810	3240	3780	4320	4750	4	120-150	1440	1920	2400	2640	3120	3600	4200	4800	5280
	70-80	1730	2305	2880	3170	3745	4320	5040	5760	6335		70-80	1920	2560	3200	3520	4160	4800	5600	6400	7040
	40-50	1860	2475	3095	3405	4025	4645	5415	6190	6810		40-50	2065	2750	3440	3785	4470	5160	6020	6880	-
4 1/2	120-150	1460	1945	2430	2675	3160	3645	4255	4860	5345	4 1/2	120-150	1620	2160	2700	2970	3510	4050	4725	5400	5940
	70-80	1945	2590	3240	3565	4210	4860	5670	6480	7130		70-80	2160	2880	3600	3960	4680	5400	6300	7200	-
	40-50	2090	2785	3485	3830	4530	5225	6095	6965	-		40-50	2320	3095	3870	4255	5030	5805	6775	-	-
5	120-150	1620	2160	2700	2970	3510	4050	4725	5400	5940	5	120-150	1800	2400	3000	3300	3900	4500	5250	6000	6600
	70-80	2160	2880	3600	3960	4680	5400	6300	7200	-		70-80	2400	3200	4000	4400	5200	6000	7000	-	-
	40-50	2320	3095	3870	4255	5030	5805	6775	-	-		40-50	2580	3440	4300	4730	5590	6450	-	-	-
5 1/2	120-150	1780	2375	2970	3265	3860	4455	5200	5940	6535	5 1/2	120-150	1980	2640	3300	3630	4290	4950	5775	6600	-
	70-80	2375	3170	3960	4355	5150	5940	6930	-	-		70-80	2640	3520	4400	4840	5720	6600	-	-	-
	40-50	2555	3405	4255	4685	5535	6385	-	-	-		40-50	2840	3785	4730	5205	6150	7095	-	-	-
6	120-150	1945	2590	3240	2565	4210	4860	5670	6480	7130	6	120-150	2160	2880	3600	3960	4680	5400	6300	7200	-
	70-80	2590	3455	4320	4750	5615	6480	-	-	-		70-80	2880	3840	4800	5280	6240	7200	-	-	-
	40-50	2785	3715	4645	5110	6035	6965	-	-	-		40-50	3095	4130	5160	5675	6710	-	-	-	-
6 1/2	120-150	2105	2810	3510	3860	4565	5265	6145	7020	-	6 1/2	120-150	2340	3120	3900	4290	5070	5850	6825	-	-
	70-80	2810	3745	4680	5150	6085	7020	-	-	-		70-80	3120	4160	5200	5720	6760	-	-	-	-
	40-50	3020	4025	5030	5515	6540	-	-	-	-		40-50	3355	4470	5590	6150	-	-	-	-	-
7	120-150	2270	3025	3780	4160	4915	5670	6615	-	-	7	120-150	2520	3360	4200	4620	5460	6300	-	-	-
	70-80	3025	4030	5040	5545	6550	-	-	-	-		70-80	3360	4480	5600	6160	7200	-	-	-	-
	40-50	3250	4335	5420	5960	7045	-	-	-	-		40-50	3610	4815	6020	6620	-	-	-	-	-
8	120-150	2590	3455	4320	4750	5615	6480	-	-	-	8	120-150	2880	3840	4800	5280	6240	7200	-	-	-
	70-80	3455	4610	5760	6335	-	-	-	-	-		70-80	3840	5120	6400	7040	-	-	-	-	-
	40-50	3715	4955	6190	6810	-	-	-	-	-		40-50	4130	5505	6880	-	-	-	-	-	-